

Product Datasheet

2-port Gigabit Single-mode Dual Fiber Media Converter (ONV1110-SCX-O)



OVERVIEW

The ONV1110-SCX-O is a gigabit fiber media converter. It has 1*10/100/1000Base-T RJ45 port and 1*1000M uplink SC/LC fiber port. User can select different optical modules, such as multi-mode dual fiber, single-mode dual fiber, and single-mode single fiber. The media converter adopts the enterprise-class Taiwan Realtek company's carrier-grade chip solution, which has stable performance, good quality and high cost performance. It is suitable for optical fiber access application scenarios such as security monitoring, wireless coverage, intelligent transportation, and safe cities to form a cost-effective and stable communication network. Unmanaged model, plug and play, no configuration, easy to use.

FEATURE

■ Gigabit photoelectric Ethernet conversion transmission

- ◇ Support non-blocking wire-speed forwarding.
- ◇ Support full-duplex based on IEEE802.3x and half-duplex based on Backpressure.
- ◇ Support gigabit RJ45 port and gigabit fiber port combination, which enables users to flexibly build networking to meet the needs of various scenarios.

■ Easy to use and simple to maintain

- ◇ Support full-duplex/half-duplex working mode with auto-negotiation function.
- ◇ Automatic identification of twisted pair MDI/MDI-X cross lines and parallel lines.
- ◇ LED working status indication for network diagnosis and fault checking, reducing maintenance workload.
- ◇ Compatible with IEEE802.3ab 1000Base-T, IEEE802.3z 1000Base-X network protocol, gigabit RJ45 port rate auto-negotiation.
- ◇ Plug and play, no configuration required, centralized power supply and centralized connection management through 2U-14 slot rack.

■ Stable and reliable

- ◇ CCC, CE, FCC, RoHS.
- ◇ Low power consumption, No fan, galvanized steel casing.
- ◇ Comply with telecommunication network access requirements, and have the telecommunications equipment network access license of the MIIT.

TECHNICAL SPECIFICATION

Model	ONV1110-MCX-O	ONV1110-SCX-O	ONV1110S-SCX-O-A/B
Interface Characteristics			
Interface	1*10/100/1000Base-T RJ45 port (Data) 1*1000M uplink SC/LC fiber port (Data)		

Ethernet Port	10/100/1000Base-T auto-sensing, full/half duplex MDI/MDI-X self-adaption		
Twisted Pair Transmission	10BASE-T: Cat3,4,5 UTP(≤100 meters) 100BASE-TX: Cat5 or later UTP(≤100 meters) 1000BASE-T: Cat5e or later UTP(≤100 meters)		
Optical Fiber Port	1.25Gbps, multi-mode dual fiber SC port	1.25Gbps, single-mode dual fiber SC port	1.25Gbps, single-mode single fiber SC port
Optical Cable/ Distance	Multi-mode: 850nm/ 0-500m, 1310nm/ 0-2km	Single-mode: 1310nm / 0-40km, 1550nm/ 0-120km	
Chip Parameter			
Network Protocol	IEEE802.3 10BASE-T, IEEE802.3i 10Base-T, IEEE802.3u 100Base-TX IEEE802.3ab 1000Base-T, IEEE802.3z 1000Base-X, IEEE802.3x		
Forwarding Mode	Store and forward(Full wire speed)		
Switching Capacity	2.0Gbps (Non-blocking)		
Forwarding Rate@64byte	3.0Mpps		
MAC	2K		
Buffer Memory	1M		
Jumbo Frame	1632byte		
LED Indicator	Power: PWR (Green) ON/OFF, Data: L/A (Green): ON/OFF/Blink Half/full duplex: FDX (Green) ON/OFF, Speed: 100/1000 (Green) ON/OFF		
Power Supply			
Total PWR / Input Voltage	3.5W/(5VDC)		
Power Consumption	Standby<1W, Full Load<4W		
Physical Parameter			
Operation TEMP / Humidity	-20°C~+55°C, 5%~90% RH Non condensing		

Storage TEMP / Humidity	-40°C~+85°C, 5%~95% RH Non condensing
Dimension (L*W*H)	94*71*26mm
Net /Gross Weight	<0.3kg / <0.5kg
Installation	Desktop, 2U-14 Rack mounted
Certification & Warranty	
Lightning Protection	Lightning protection: 4KV 8/20us, Protection level: IP30
Certification	CCC, CE mark, commercial, CE/LVD EN62368-1, FCC Part 15 Class B, RoHS
Warranty	3 years, lifelong maintenance.

DIMENSION

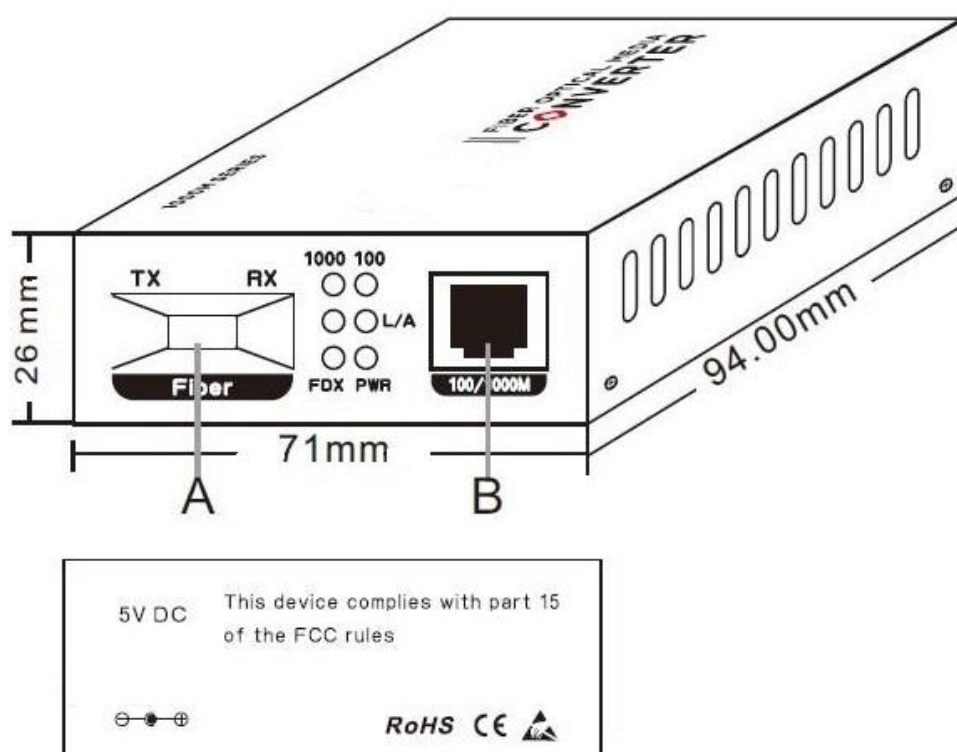

A. 1.25G SC fiber port

B. 1*10/100/1000M RJ45 port

C. DC5V power input port

APPLICATION

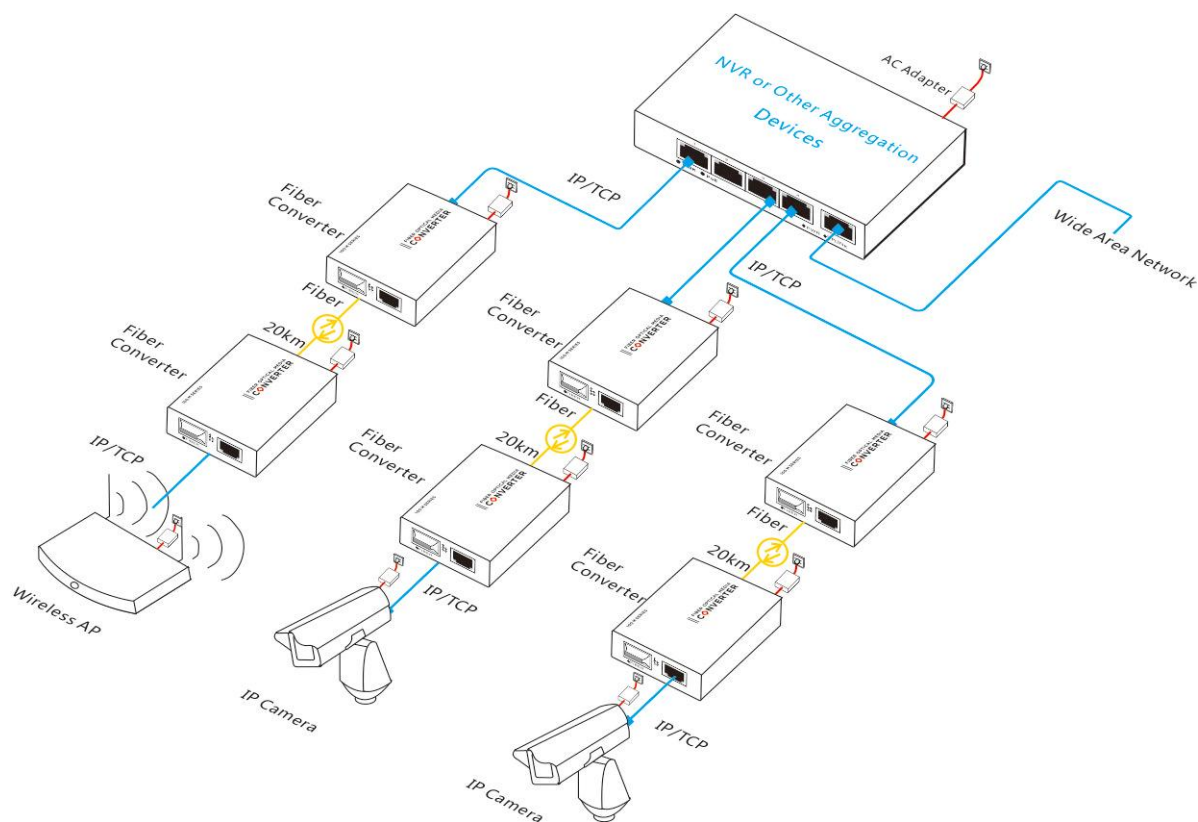

ORDERING INFORMATION

Model	Description
ONV1110-MCX-O	Gigabit multi-mode dual fiber media converter with 1*10/100/1000M RJ45 port and 1*1.25G SC fiber port. 850nm/ 0-550m. Total power is 4W. External power supply: AC100-240V input.
ONV1110-SCX-O	Gigabit single-mode dual fiber media converter with 1*10/100/1000M RJ45 port and 1*1.25G SC fiber port. 1310nm/ 0-20km. Total power is 4W. External power supply: AC100-240V input.
ONV1110S-SCX-O-A	Gigabit single-mode single fiber media converter with 1*10/100/1000M RJ45 port and 1*1.25G SC fiber port. 1310nm/ 0-20km. Total power is 4W. External power supply: AC100-240V input.

ONV1110S-SCX-O-B	Gigabit single-mode single fiber media converter with 1*10/100/1000M RJ45 port and 1*1.25G SC fiber port. 1550nm/0-20km. Total power is 4W. External power supply: AC100-240V input.
ONV1110-MCX-K	Gigabit multi-mode dual fiber media converter with 1*10/100/1000M RJ45 port and 1*1.25G SC fiber port. 850nm/ 0-550m. Total power is 4W. Support one-click switch LFP enable and store-forward/ pass-through forwarding. External power supply: AC100-240V input.
ONV1110-SCX-K	Gigabit single-mode dual fiber media converter with 1*10/100/1000M RJ45 port and 1*1.25G SC fiber port. 1310nm/0-20km. Total power is 4W. Support one-click switch LFP enable and store-forward/ pass-through forwarding. External power supply: AC100-240V input.
ONV1110S-SCX-K-A	Gigabit single-mode single fiber media converter with 1*10/100/1000M RJ45 port and 1*1.25G SC fiber port. 1310nm/0-20km. Total power is 4W. Support one-click switch LFP enable and store-forward/ pass-through forwarding. External power supply: AC100-240V input.
ONV1110S-SCX-K-B	Gigabit single-mode single fiber media converter with 1*10/100/1000M RJ45 port and 1*1.25G SC fiber port. 1550nm/0-20km. Total power is 4W. Support one-click switch LFP enable and store-forward/ pass-through forwarding. External power supply: AC100-240V input.
ONV1110-MLX-F	Gigabit multi-mode dual fiber media converter with 1*10/100/1000M RJ45 port and 1*1.25G SFP fiber port. 850nm/ 0-550m. Total power is 4W. External power supply: AC100-240V input.
ONV1110-SLX-F	Gigabit single-mode dual fiber media converter with 1*10/100/1000M RJ45 port and 1*1.25G SFP fiber port. 1310nm /0-20km. Total power is 4W. External power supply: AC100-240V input.
ONV1110S-SLX-F-A	Gigabit single-mode single fiber media converter with 1*10/100/1000M RJ45 port and 1*1.25G SFP fiber port. 1310nm/0-20km. Total power is 4W. External power supply: AC100-240V input.
ONV1110S-SLX-F-B	Gigabit single-mode single fiber media converter with 1*10/100/1000M

RJ45 port and 1*1.25G SFP fiber port. 1550nm/ 0-20km. Total power is 4W.
External power supply: AC100-240V input.

PACKING LIST

	Content	Qty	Unit
Packing List	2-port gigabit single-mode dual fiber media converter	1	SET
	User Guide	1	PC
	Warranty Card	1	PC

CONTACT US



Optical Network Video Technologies (Shenzhen) Co., Ltd.

Tel: 0086-755-33376606

Fax: 0086-755-33376608

WeChat: ONV-PoE-IoT

Email: onv@onv.com.cn

Skype: onv@onv.com.cn

Website: www.onvcom.com

Headquarter Address: Room 1003, Block D, Terra Building, Futian District, Shenzhen, China

Factory Address: Floor 4-6, Building A, Senyutai Industrial Park, No. 111, Huaning Road, Xinshi

Community, Dalang Street, Longhua District, Shenzhen, China

