

## Product Datasheet

# 24-Port 10G Uplink L2+ Managed Industrial PoE Switch

(ONV-IPS36248PFM)

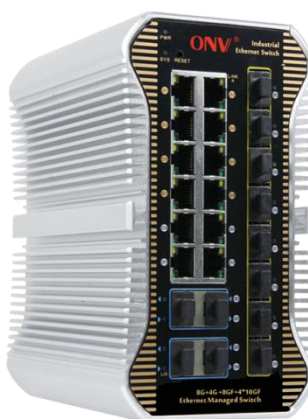

## OVERVIEW

The ONV-IPS36248PFM is a L2+ 10G uplink managed industrial PoE fiber switch independently developed by ONV. It has 12\*10/100/1000Base-T RJ45 ports and 8\*100/1000Base-X SFP fiber slot ports and 4\*1/10G SFP+ fiber slot ports. Port 1-8 can support IEEE 802.3af/at standard POE, single port POE power up to 30W, and the maximum POE output power of the whole machine is 120W(at-240W). As a PoE power supply device, it can automatically detect and recognize the power receiving equipment that meets the standard and supply power through the network cable. It can supply power to POE terminal equipment such as wireless AP, webcam, VoIP phone, industrial sensor through network cable, and meet the network environment that needs high-density PoE power supply. It is suitable for intelligent transportation, rail transit, electric power, mining, metallurgy and green energy. Industrial scenes such as construction set up a cost-effective and stable communication network.

The ONV-IPS36248PFM has L2+ full network management, supports IPV4/IPV6 management, static route full line rate forwarding, security protection mechanism,

ACL/QoS policy and VLAN, and is easy to manage and maintain. It has the leading ring network technology, supporting a variety of industrial redundant ring network protocol, any port can be a ring, support chain type, star type, double star type, ring type, tangent ring, intersecting ring, coupling ring, ring network 20ms self healing. It has high reliability, security and manageability, ensure reliable transmission of key data, support remote management, and can manage cluster management with ONV-NMS network management platform. ONV-IPS36248PFM industrial series products fully follow industrial product design and material. The casing uses aluminum alloy to enhance heat dissipation. It has excellent industrial field environment adaptability (including mechanical stability, climate and environment adaptability, electromagnetic environment adaptability, etc.), Protection level is IP40, support dual power supply, low power consumption no fan heat dissipation technology, MTBF average fault free working time can reach 35 years, 5 years warranty.

## FEATURE

### ■ Full gigabit port ,10G uplink

- ◇ All series supports Ethernet port and SFP port combination, which enables users to flexibly build networking to meet the needs of various scenarios.
- ◇ Support non-blocking wire-speed forwarding.
- ◇ Support full-duplex based on IEEE802.3x and half-duplex based on backpressure.



## ■ Intelligent PoE power supply

- ◇ 8\*10/100/1000Base-T RJ45 ports, meeting the needs of security monitoring, teleconferencing system, wireless coverage, and other scenarios.
- ◇ IEEE 802.3af/at PoE standard, without damaging non-PoE devices.
- ◇ PoE network management, realize PoE port power allocation, priority setting, port power status viewing, time scheduling, etc.

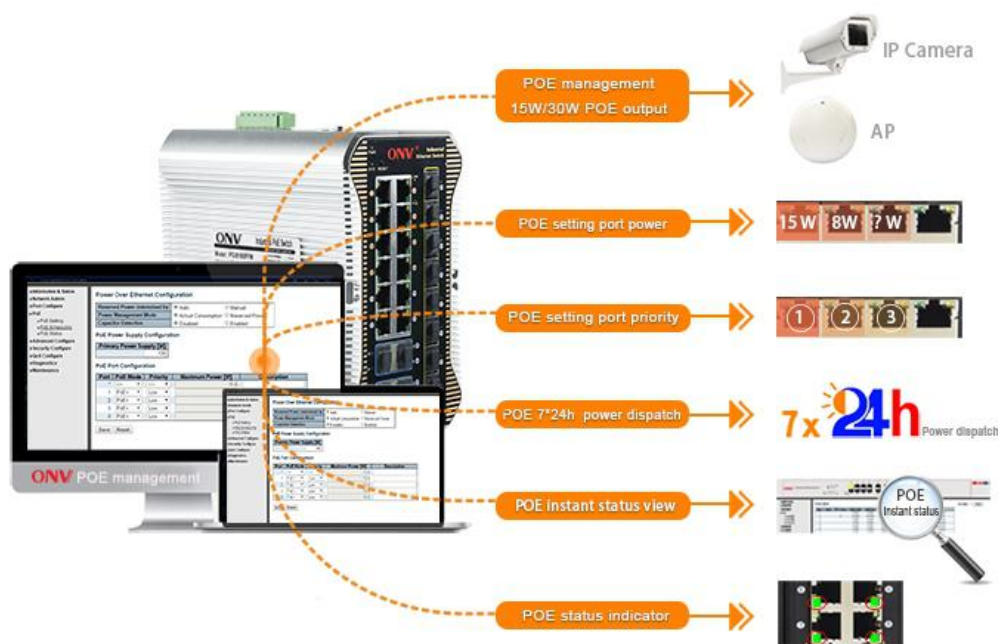

## ■ Strong business processing capability

- ◇ IEEE802.1Q VLAN, flexible VLAN division, Voice VLAN and QinQ configuration.
- ◇ QoS, Priority mode based on 802.1P, Port & DSCP, queue scheduling algorithm including Equ, SP, WRR & SP+WRR.
- ◇ ALC, filter data packet through configuring matching rules, processing operation & time permission, and provide flexible and safe access control.
- ◇ IGMP V1/V2 and IGMP Snooping.
- ◇ ERPS/STP/RSTP/MSTP.
- ◇ Static and dynamic aggregation.

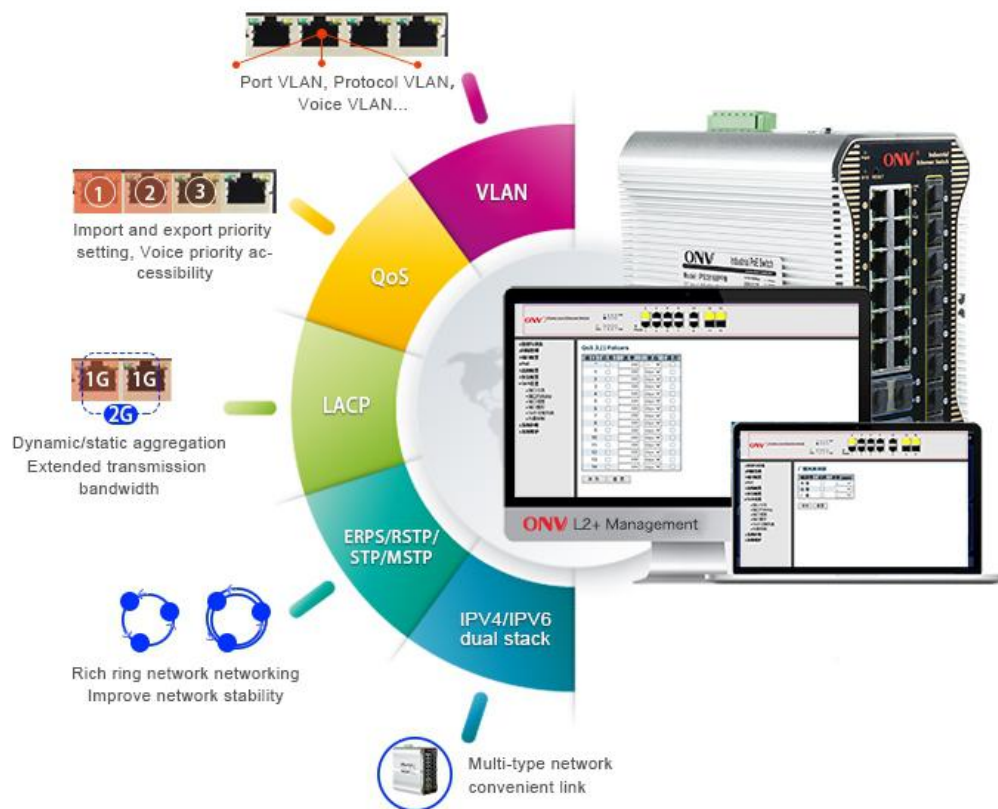

## ■ Security

- ◇ 802.1X authentication.
- ◇ Port isolation, Storm control.
- ◇ IP-MAC-VLAN-Port binding.

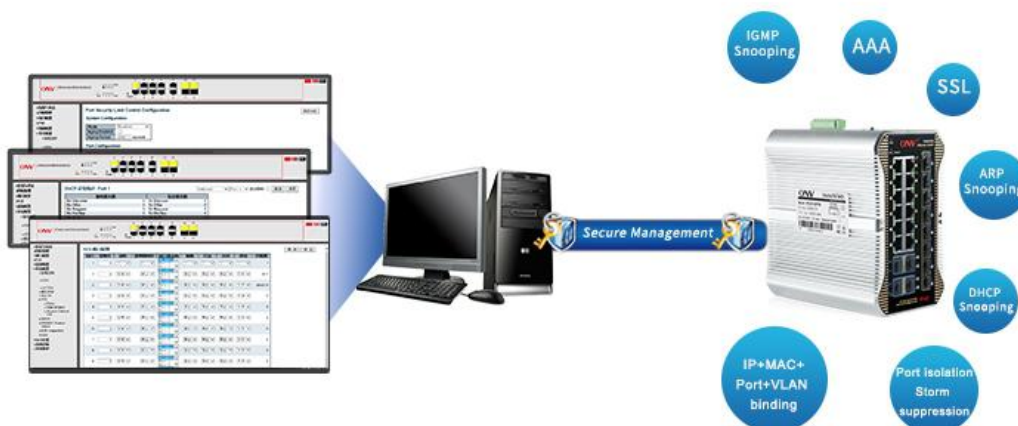

## ■ Stable and reliable

- ◇ CCC, CE, FCC, RoHS.
- ◇ Low power consumption, no fan, aluminum casing.

- ◇ The user-friendly panel, it can show the device status through the LED indicator of PWR, Link, PoE.

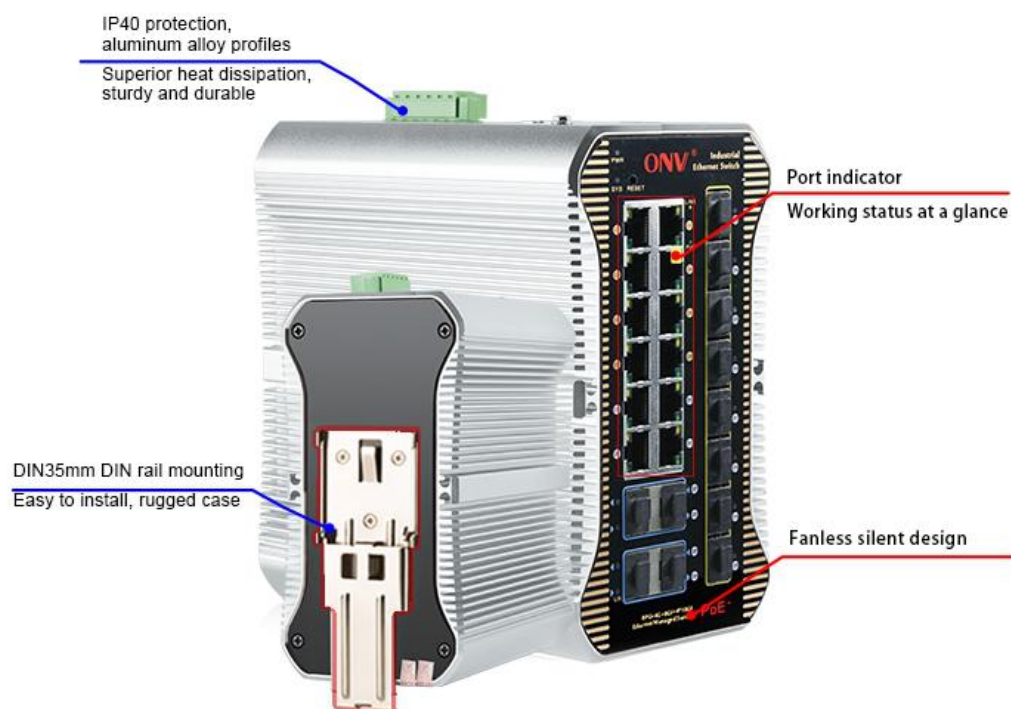

### ■ Easy operation and maintenance management

- ◇ HTTPS, SSLV3, and SSHV1/V2.
- ◇ RMON, system log, LLDP, and port traffic statistics.
- ◇ CPU monitoring, memory monitoring, Ping test, and cable diagnose.
- ◇ Web management, CLI command line (Console, Telnet), SNMP (V1/V2/V3).

## TECHNICAL SPECIFICATION

Model	ONV-IPS36248PFM	ONV-IPS36248PFM-at
<b>Interface Characteristics</b>		
Fixed Port	8*10/100/1000Base-T PoE ports (Data/Power)	
	4*10/100/1000Base-T uplink RJ45 ports (Data)	
	8*100/1000Base-X uplink SFP slot ports (Data)	

	4*1/10G uplink SFP+ slot ports (Data) 1 * RS232 console port(115200,N,8,1) 2 set of V+, V- redundant DC power interface (6 Pin Phoenix terminal) Power off alarm switch (FAULT)
Ethernet Port	Port 1-8 support 10/100/1000Base-T, auto-sensing, Full/half duplex MDI/MDI-X self-adaption
Twisted Pair Transmission	10BASE-T: Cat3,4,5 UTP(≤100 meter) 100BASE-TX: Cat5 or later UTP(≤100 meter) 1000BASE-T: Cat5e or later UTP(≤100 meter)
Optical Fiber Port	Gigabit SFP optical fiber interface, default matching optical modules (optional order single-mode / multi-mode, single fiber / dual fiber optical module. LC)
Optical Cable/ Distance	Multi mode: 850nm / 0 ~ 500M(1.25G); single mode: 1310nm / 0 ~ 40KM, 1550nm 0 ~ 120KM.
<b>Chip Parameter</b>	
Network Management Type	L2+
Network Protocol	IEEE802.3 10BASE-T, IEEE802.3i 10Base-T IEEE802.3u 100Base-TX , IEEE802.3ab 1000Base-T IEEE802.3z 1000Base-X IEEE802.3ae 10GBase-LR/SR IEEE802.3x
Forwarding Mode	Store and Forward(Full Wire Speed)
Switching Capacity	598Gbps
Forwarding Rate@64byte	89.28Mpps
MAC	32K
Buffer Memory	32M
Jumbo Frame	9.6K



LED Indicator	Power: PWR (green), System : SYS (green), Network: Link (yellow); Fiber Port : L/A (green), PoE: PoE (green)	
Reset Switch	Yes, One-button factory reset	
PoE & Power		
PoE Port	Port 1 to 8	
PoE Management	PoE working status	
	Delay start of power supply	
	PoE output priority configuration	
	Scheduling of PoE operation and time	
	Total power limit of PoE power supply	
	PoE output power allocation, off& af &at	
Power Supply Pin	Default: 1/2 (+), 3/6 (-)	
Max Power Per Port	30W, IEEE802.3af/at	
Total PWR / Input Voltage	120W (48VDC)	240W (48VDC)
Power Consumption	Standby<18W, Full load<120W	Standby<25W, Full load<240W
Working Voltage	48-57VDC, 6 Pin industrial Phoenix terminal, support anti-reverse protection.	
Power Supply	No, optional 48V/120W or 48V/240W industrial power supply	
Physical Parameter		
Operation TEMP / Humidity	-40~+80°C;5%~90% RH Non condensing	
Storage TEMP / Humidity	-40~+85°C;5%~95% RH Non condensing	
Dimension (L*W*H)	166*149*89mm	
Net /Gross Weight	<1.5kg / <1.8kg	
Installation	Desktop, DIN rail	
Certification & Warranty		

Lightning protection / protection level	<p>Lightning protection: 6KV 8/20us; Protection level: IP40</p> <p>IEC61000-4-2(ESD):±8kV contact discharge,±15kV air discharge</p> <p>IEC61000-4-3(RS):10V/m(80~1000MHz)</p> <p>IEC61000-4-4(EFT): power cable:±4kV; data cable:±2kV</p> <p>IEC61000-4-5(Surge):power cable:CM±4kV/DM±2kV; data cable:±4kV</p> <p>IEC61000-4-6(radio frequency transmission):10V(150kHz~80MHz)</p> <p>IEC61000-4-8(power frequency magnetic field):100A/m;1000A/m ,1s to 3s</p> <p>IEC61000-4-9(pulsed magnet field):1000A/m</p> <p>IEC61000-4-10(damped oscillation):30A/m 1MHz</p> <p>IEC61000-4-12/18(shockwave):CM 2.5kV,DM 1kV</p> <p>IEC61000-4-16(common-mode transmission):30V; 300V,1s</p> <p>FCC Part 15/CISPR22(EN55022):Class A</p> <p>IEC61000-6-2(Common Industrial Standard)</p>
Mechanical Properties	<p>IEC60068-2-6 (anti vibration)</p> <p>IEC60068-2-27 (anti shock)</p> <p>IEC60068-2-32 (free fall)</p>
Certification	CCC;CE mark, commercial; CE/LVD EN60950;FCC Part 15 Class B; RoHS;
Warranty	5 years , lifelong maintenance.
<b>Network Management Features</b>	
Interface	<p>IEEE802.3X (Full-duplex)</p> <p>Port temperature protection setting</p> <p>Port green Ethernet Energy-saving setting</p> <p>Broadcast storm control based on port speed</p> <p>The speed limit of the message flow in the access port.</p> <p>The minimum particle size is 64Kbps.</p>
Layer 3 Features	<p>L2+ network management ,IPV4/IPV6 management</p> <p>L3 soft routing forwarding,</p>



	Static route, Default route @ 128 pcs, APR @ 1024 pcs
VLAN	4K VLAN based on port, IEEE802.1q VLAN based on the protocol VLAN based on MAC Voice VLAN, QinQ configuration Port configuration of Access, Trunk, Hybrid
Port Aggregation	LACP, Static aggregation Max 12 aggregation groups and 8 ports per group.
Spanning Tree	STP (IEEE802.1d), RSTP (IEEE802.1w), MSTP (IEEE802.1s)
Industrial Ring	G.8032 (ERPS), Recovery time less than 20ms
Network Protocol	250 Ring at most, Max 250 devices per ring.
Multicast	MLD Snooping v1/v2, Multicast VLAN IGMP Snooping v1/v2, Max 1024 multicast groups, Fast log out
Port Mirroring	Bidirectional data mirroring based on port
QoS	Flow-based Rate Limiting Flow-based Packet Filtering 8*Output queues of each port 802.1p/DSCP priority mapping Diff-Serv QoS, Priority Mark/Remark Queue Scheduling Algorithm (SP, WRR, SP+WRR)
ACL	Port-based Issuing ACL, ACL based on port and VLAN L2 to L4 packet filtering, matching first 80 bytes message. Provide ACL based on MAC, Destination MAC address, IP Source, Destination IP, IP Protocol Type, TCP/UDP Port, TCP/UDP Port Range, and VLAN, etc.
Security	IP-MAC-VLAN-Port binding ARP inspection, Anti-DoS attack AAA & RADIUS, MAC learning limit Mac black holes, IP source protection IEEE802.1X & MAC address authentication

	<p>Broadcast storm control, Backup for host datum</p> <p>SSH 2.0, SSL, Port isolation, ARP message speed limit</p> <p>User hierarchical management and password protection</p>
DHCP	DHCP Client, DHCP Snooping, DHCP Server, DHCP Relay
Management	<p>One-key recovery</p> <p>Cable Diagnose, LLDP</p> <p>Web Management (HTTPS)</p> <p>NTP, System work log, Ping Test</p> <p>CPU instant utilization status view</p> <p>Console/AUX Modem/Telnet/SSH2.0 CLI</p> <p>Download &amp; Management on FTP, TFTP, Xmodem, SFTP, SNMP</p> <p>V1/V2C/V3</p> <p>ONV NMS - smart network management system platform (LLDP+SNMP)</p>
System	<p>Category 5 Ethernet network cable</p> <p>Web browser: Mozilla Firefox 2.5 or higher, Google browser chrome V42 or higher, Microsoft Internet Explorer 10 or later;</p> <p>TCP/IP, network adapter, and network operating system (such as Microsoft Windows, Linux, or Mac OS X) installed on each computer in a network</p>

## DIMENSION

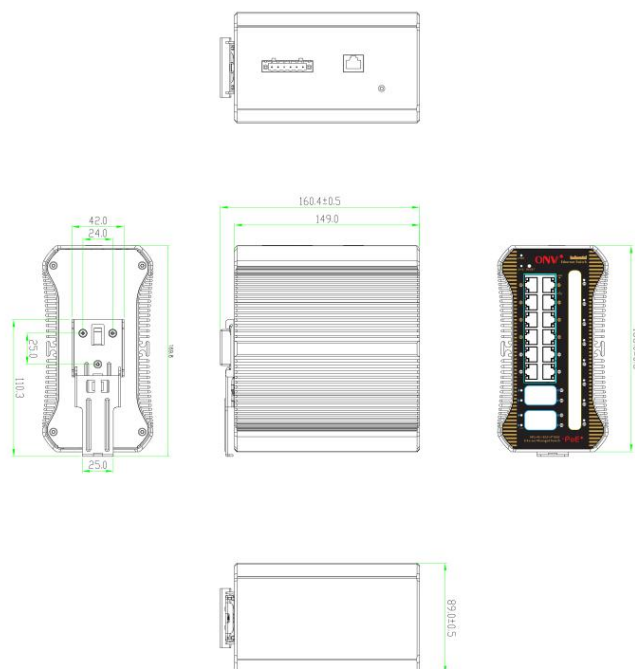

## APPLICATION

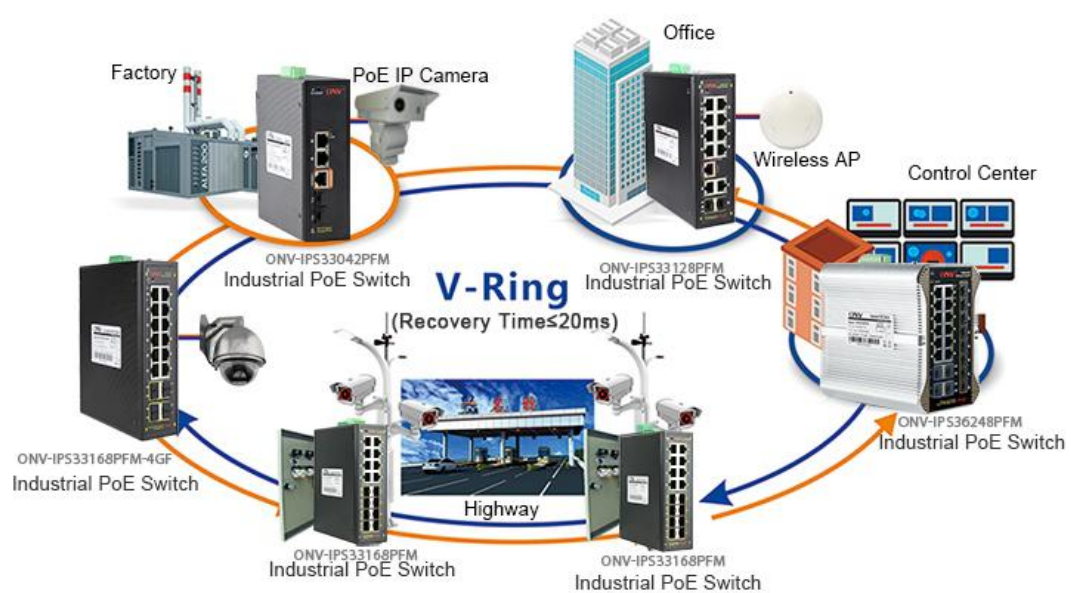

## ORDERING INFORMATION

Model	Description	Recommended power supply
ONV-IPS36248PFM	L2+ managed industrial PoE fiber switch with 12*10/100/1000M RJ45 ports and 8*100/1000M SFP slot ports and 4*1/10G uplink SFP+ slot ports , Port 1-8 can support IEEE802.3af/at PoE. Support DC dual power supply input and DIN rail mounting.	120W
ONV-IPS36248PFM-at		240W

**Note:** Industrial PoE switch does not match the SFP optical module and power supply.

## PACKING LIST

PACKING LIST	CONTENT	QTY	UNIT
	24-port 10G uplink L2+ managed industrial PoE switch	1	SET
	RJ45-DB9 Line	1	PC
	User Guide	1	PC
	Warranty Card	1	PC

## OPTICAL MODULE INFORMATION

Product	Model	Description	Unit
1.25G Optical Module	ONV-2630	SFP optical module, 1.25G, multi mode dual fiber 850nm, transmission distance: 550m, LC interface, support DDM function, support hot plug and pull.	PC

	ONV-2632	SFP optical module, 1.25G, single-mode dual fiber 1310nm, transmission distance: 20km, LC interface, support DDM function, support hot plug and pull.	PC
	ONV-2612-T	SFP optical module, 1.25G, single-mode single fiber TX1310nm/RX1550nm, transmission distance: 20km, LC interface, support DDM function, support hot plug and pull.	PC
	ONV-2613-R	SFP optical module, 1.25G, single-mode single fiber TX1550nm/RX1310nm, transmission distance: 20km, LC interface, support DDM function, support hot plug and pull.	PC
	2612-T-G	Industrial SFP optical module, 1.25G, single-mode single fiber TX1310nm/RX1550nm, transmission distance: 20km, LC interface, support DDM function, support hot plug and pull.	PC
	2613-R-G	Industrial SFP optical module, 1.25G, single-mode single fiber TX1550nm/RX1310nm, transmission distance: 20km, LC interface, support DDM function, support hot plug and pull.	PC
	ONV-2612-T-S C	SFP optical module, 1.25G, single-mode single fiber TX1310nm/RX1550nm, transmission distance: 20km, SC interface, support DDM function, support hot plug and pull.	PC
	ONV-2613-R-S C	SFP optical module, 1.25G, single-mode single fiber TX1550nm/RX1310nm, transmission distance: 20km, SC interface, support DDM function, support hot plug and pull.	PC
Power Module	ONV-2633	1.25G SFP optical module transfers to 10/100/1000M RJ45 port.	PC

10G Optical Module	ONV-6630	SFP+ optical module, 10G Multi-mode dual fiber 850nm, transmission distance: 300m, LC interface, support DDM function, support hot plug and pull.	PC
	ONV-7832	SFP+ optical module, 10G Single-mode dual fiber 1310nm, transmission distance: 20km, LC interface, support DDM function, support hot plug and pull.	PC
	ONV-7832-33	SFP+ optical module, 10G Single-mode single fiber TX1330nm/RX1270nm , transmission distance: 20km, LC interface, support DDM function, support hot plug and pull.	PC
	ONV-7832-27	SFP+ optical module, 10G Single-mode single fiber TX1270nm/RX1330nm , transmission distance: 20km, LC interface, support DDM function, support hot plug and pull.	PC

## POWER SUPPLY SELECTION TABLE

Product	Model	Description	Unit
130W Desktop Power Adaptor	GWS-AP130-52	Desktop tape 130W single set of output power adapter; Input Voltage: AC 100V~240V 50-60Hz, 2.3A Output Voltage: DC 52V 2.5A Operation Temperature: -20℃—+65℃	PC
250W Desktop Power Adaptor	GWS-AP250-52	Desktop tape 250W single set of output power adapter; Input Voltage: AC 100V~240V 50-60Hz, 4.1A Output Voltage: DC 52V 4.8A Operation Temperature: -20℃—+65℃	PC



120W DIN Rail Industrial Power Supply	GWS-DP120-48	Din Rail type 120W single set of output power supply; Input Voltage:AC 100V~240V 50-60Hz,1.5A Output Voltage:DC 48V 2.5A Operation Temperature:-40℃—+70℃	PC
240W DIN Rail Industrial Power Supply	GWS-DP240-48	Din Rail type 240W single set of output power supply; Input Voltage:AC 100V~240V 50-60Hz,3A Output Voltage:DC 48V 5A Operation Temperature:-40℃—+70℃	PC
480W DIN Rail Industrial Power Supply	GWS-DP480-48	Din Rail type 480W single set of output power supply; Input Voltage:AC 100V~240V 50-60Hz,5A Output Voltage:DC 48V 10A Operation Temperature:-40℃—+70℃	PC

## RELATED PRODUCT

Model	Description
ONV-IPS33168PFM-4 GF	L2+ managed industrial PoE fiber switch with 12*10/100/1000M RJ45 ports and 4*100/1000M SFP slot ports . Port 1-8 can support IEEE802.3af/at PoE. Support DC dual power supply input and DIN rail mounting.
ONV-IPS33248PFM	L2+ managed industrial PoE fiber switch with 12*10/100/1000M RJ45 ports and 12*100/1000M SFP slot ports , Port 1-8 can support IEEE802.3af/at PoE. Support DC dual power supply input and DIN rail mounting.

ONV-IPS33248PFM-4 GF	L2+ managed industrial PoE fiber switch with 20*10/100/1000M RJ45 ports and 4*100/1000M SFP slot ports, Port 1-8 can support IEEE802.3af/at PoE. Support DC dual power supply input and DIN rail mounting.
ONV-IPS38168PFM	L3 managed industrial PoE fiber switch with 12*10/100/1000M RJ45 ports and 4*1/10G uplink SFP+ slot ports , Port 1-8 can support IEEE802.3af/at PoE. Support DC dual power supply input and DIN rail mounting.
ONV-IPS38248PFM	L3 managed industrial PoE fiber switch with 12*10/100/1000M RJ45 ports and 8*100/1000M SFP slot ports and 4*1/10G uplink SFP+ slot ports , Port 1-8 can support IEEE802.3af/at PoE. Support DC dual power supply input and DIN rail mounting.
ONV-IPS38248PFM-8 G	L3 managed industrial PoE fiber switch with 20*10/100/1000M RJ45 ports and 4*1/10G uplink SFP+ slot ports , Port 1-8 can support IEEE802.3af/at PoE. Support DC dual power supply input and DIN rail mounting.

## CONTACT US



OPTICAL NETWORK VIDEO TECHNOLOGIES (SHENZHEN) CO., LTD.

Tel: 0086-755-33376606

Fax: 0086-755-33376608

Email: [onv@onv.com.cn](mailto:onv@onv.com.cn)

Website: [www.onvcom.com](http://www.onvcom.com)

Zip: 518000

Headquarter Address: Room 1003, Block D, Terra Building, Futian District, Shenzhen,  
China

Factory Address: The 4-6th Floor, No. 59, Huaning Road, Xinwei Community, Dalang  
Street, Longhua District, Shenzhen, China

